

<b>nominal voltage</b>	1.2 V
<b>max. charge voltage</b>	1.5 V
<b>capacity</b>	
nominal	2000mAh
minimal	>1700 mAh
typical	1800mAh
<b>max. discharge current</b>	30A
<b>charge</b>	charge current
standard charge	200 mA
quick charge	2000 mA
recommended charge	-dV
termination control	dT/dt
parameters	TCO
trickle charge current	50...100 mA
continuous overcharge (less than 1 year)	<200 mA
<b>internal resistance</b>	Average 6 mOhms (4~8mOhms)
<b>life expectancy</b>	>500 cycles
<b>Charge retention</b>	>1400mAh
<b>ambient temperature range</b>	0...45°C 10...45°C -20...50°C -10...45°C -10...35°C

**conditions**

at standard charge (0.1C/20°C)  
 discharge at 0.2C  
 discharge at 30A  
 discharge at 30A  
 0.8V end discharge voltage  
 ambient temperature 20°C  
 ambient temperature 20...50°C  
 charge time 15hrs at 20°C  
 1.05hrs for empty battery  
 0...5 mV  
 0.8...1°C per min  
 40...45°C  
 (recommended)

no conspicuous deformation  
 no leakage

at 1000Hz  
 battery fully charged

IEC61951-2 standard

discharge at 0.2C after storage 28 days at 20+/-5°C  
 standard charge  
 fast charge  
 discharge  
 storage less than 3 months  
 storage less than 1 year

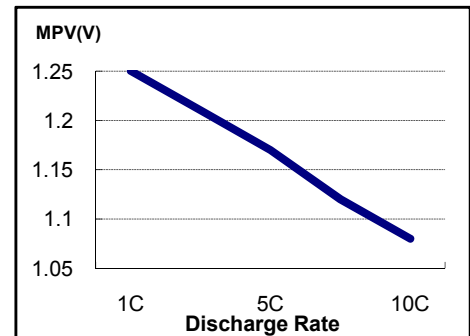
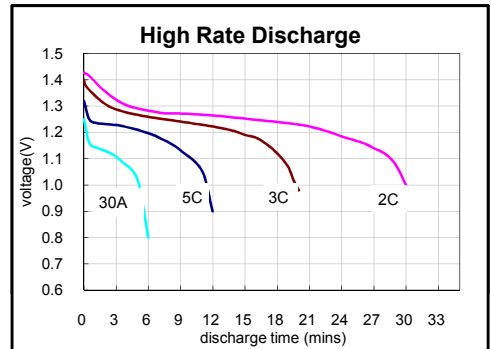
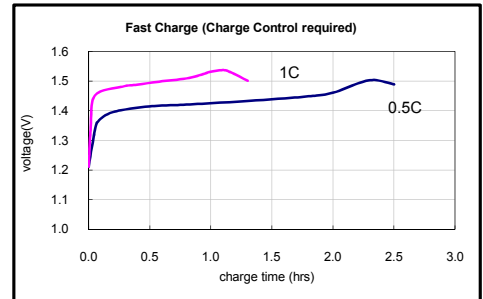
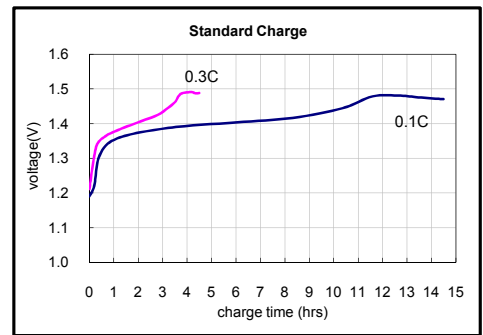
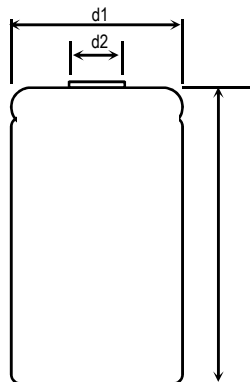

**mechanical specifications**

cell dimensions (with sleeve)  
 diameter d1 23.0-0.5 mm  
 diameter d2 9.1+/-0.5 mm  
 height h1 44-0.5 mm  
 weight approx. 52 g

DATA SHEET FOR	Ni-MH SC 2000mAh
VAPEXTECH DRAWING	VP2000SC
DRAWN BY / DATE	2010/2/20

Manufacturer reserves the right to alter or amend the design, model and specification without prior notice.